

## Biometric Hotel Door Lock / 304 Stainless Steel Hotel Smart Door Lock

### Our Product Introduction

#### Basic Information

- Place of Origin: Guangdong, China
- Brand Name: ELA
- Certification: ROHS/CE/EN14846/ISO9001
- Model Number: H8019
- Minimum Order Quantity: 100 sets
- Price: Negotiable
- Packaging Details: Security Bluetooth Electronic Hotel Keyless  
High Quality Combination Silm Smart Door  
Lock  
Inner Paper Packing:180mm\*325mm\*135mm  
One piece per box  
Outside Paper  
Carton:680mm\*380mm\*385mm 8 pieces per  
carton.G.W:23.5KG



#### Product Specification

- Product Name: Biometric Hotel Door Lock
- Application: Apartments / Hotel
- Color: Silver, black, gold
- Door Thickness: 35-90mm
- PMS: Fidelio, Opera, Others
- Door Type: Glass Door, Wood Door, Steel Door,  
Stainless Steel Door, Aluminum Door
- Unlock Way: Card+Mechanical Key
- Warranty: 2 Years
- Material: 304 Stainless Steel
- Port: Shenzhen/goangzhou
- Motise: American Standard
- Highlight: **Biometric Hotel Door Lock,  
SS304 Hotel Smart Door Lock,  
Stainless Steel Hotel Smart Door Lock**



## Product Description

# Smart Hotel Lock door lock with biometric hotel lock

parts	Material	Technology surface treatment
lock tongue	Zinc Alloy	Light branding
side tongue	Zinc Alloy	Light branding
panel	304 stainless steel	Anodizing
handle	304 stainless steel	Anodizing
for lock core	HD#(62*95mm)	HK#(70*95mm)

## Product Description

The lock typically includes biometric authentication technology, such as fingerprint recognition or facial recognition, which can provide an additional layer of security. This can be particularly useful in hotels and other hospitality industries, where guests may not always have their physical keys with them. Some advanced biometric hotel locks may also offer additional features such as remote access, real-time monitoring, and integration with other hotel systems.





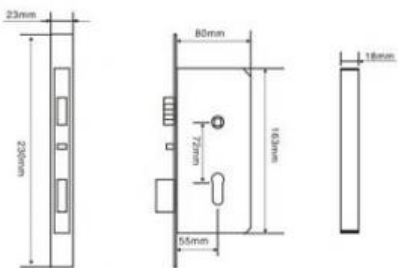
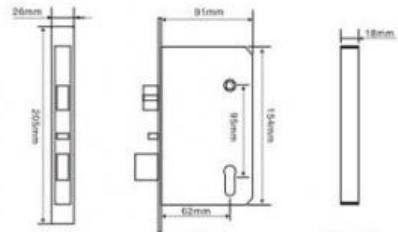
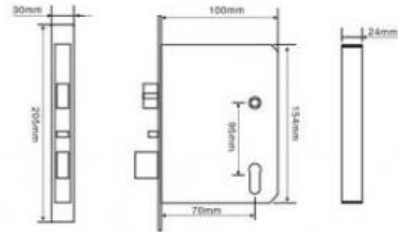

## Product packaging

Smart Hotel Lock door lock with biometric hotel lock

1.Packing Size(W\*D\*H):490\*360\*450mm

2.Package sort:PP bag+foam

3.Net/Gross Weight(KGS):17.5/17.8

4.Qty/Carton:6 pieces in one carton

DELIVERY TIME of ela HOTEL LOCK:

ELA hotel lock will be delivered within 7-15 workdays according to your quantity. And we have very good cooperation relation ship with shipping cost, it can help to save cost for you. No matter you choose DHL, FEDEX, UPS, EMS or other transportation way, we will find the best solution for you.



## Company Profile

### CULTURE

March 2016 Honglg Electronic Factory is updated to Dongguan Yinlang Electronic Technology Col,Ltd. Welcome new and old customersto visit our company.

About ELA:

Established in 2002 initially name was Dongguan Shijie HongLG Electronic Factory;

In 2004 manufactured the first aluminum alloy material electronic hotel lock in China;

In 2005 manufactured the first split model electronic hotel lock HD8018, HD8019 in China;

In 2006 supplied over 2000 locks for Doha Asia Games Athlete apartment.;

In 2007 developed the first biometric fingerprint lock;

In2009 supplied for 2nd Summer Youth Olympic Games Athlete apartment;

In 2011 supplied for 10th national games Athlete apartment;

In 2012 the first face recognition lock in China;

In 2013 supplied for 12th National Games Athlete apartment;

In 2016 updated to Dongguan Yinlang Electronic Technology Co. Ltd

We keep moving....





reception



Product parts



working



working environment



work shop



staff member



## Certifications

---

## Our services

---

### ELA HOTEL LOCK SERVICE:

1. 2% of contract spare parts, which includes motor, battery case and PCB.
2. Hole Opening Diagram., Installation Manual Book , Installation Video &Software CD.
3. Door Strike Plate, Metal Strike plate box.
4. Sales after service: 2 years warranty and life time free service. During this period any spare parts damaged by lock itself, we will change for free.



## OEM services

1. logo on Devnce
2. Welcome Screen
3. Pre-installed APP
4. Android Settings
5. Packing Box

## ODM services

1. PCAB Design & Developmet
2. Tooling Design & Development
3. Software Customization.

 **Yinlang** Dongguan Yinlang Electronic Technolog Co.,Ltd



13926821097



Linda@honglg.com



smartdoor-lock.com

10-3 The First Industrial Park, Chong Huan West Road, Shijie town, Dongguan City, Guangdong, China