

Combination Slim Smart Hotel Lock , Electronic Door Lock With Biometric

Our Product Introduction

Basic Information

- Place of Origin: Guangdong, China
- Brand Name: ELA
- Certification: ROHS/CE/EN14846/ISO9001
- Model Number: H01
- Minimum Order Quantity: 100 sets
- Price: Negotiable
- Packaging Details: Security Bluetooth Electronic Hotel Keyless
High Quality Combination Slim Smart Door
Lock
Inner Paper Packing:180mm*325mm*135mm
One piece per box
Outside Paper
Carton:680mm*380mm*385mm 8 pieces per
carton.G.W:23.5KG



Product Specification

- Door Type: Glass Door, Wood Door, Steel Door, Stainless Steel Door, Aluminum Door
- Data Storage Options: Cloud
- Network: SDK
- Product Name: Smart Electronic Hotel Keyless Smart Portable Hotel Door Lock
- Application: Apartments
- Color: Silver, black
- Weight: 3.5kgs
- Door Thickness: 35-90mm
- PMS: Fidelio、Opera、Others
- Unlock Way: Card+Mechanical Key
- Warranty: 2 Years
- Material: 304 Stainless Steel
- Port: Shenzhen/goangzhou

Product Description

High Quality Combination Silm Smart Hotel Lock door lock with biometric

parts	Material	Technology surface treatment
lock tongue	Zinc Alloy	Light branding
side tongue	Zinc Alloy	Light branding
panel	304 stainless steel	Anodizing
handle	304 stainless steel	Anodizing
for lock core	HD#(62*95mm)	HK#(70*95mm)

Product Description

With its electronic keypad and biometric sensors, this lock ensures that only authorized individuals can unlock the door, providing a reliable level of security for hotels and other hospitality establishments.



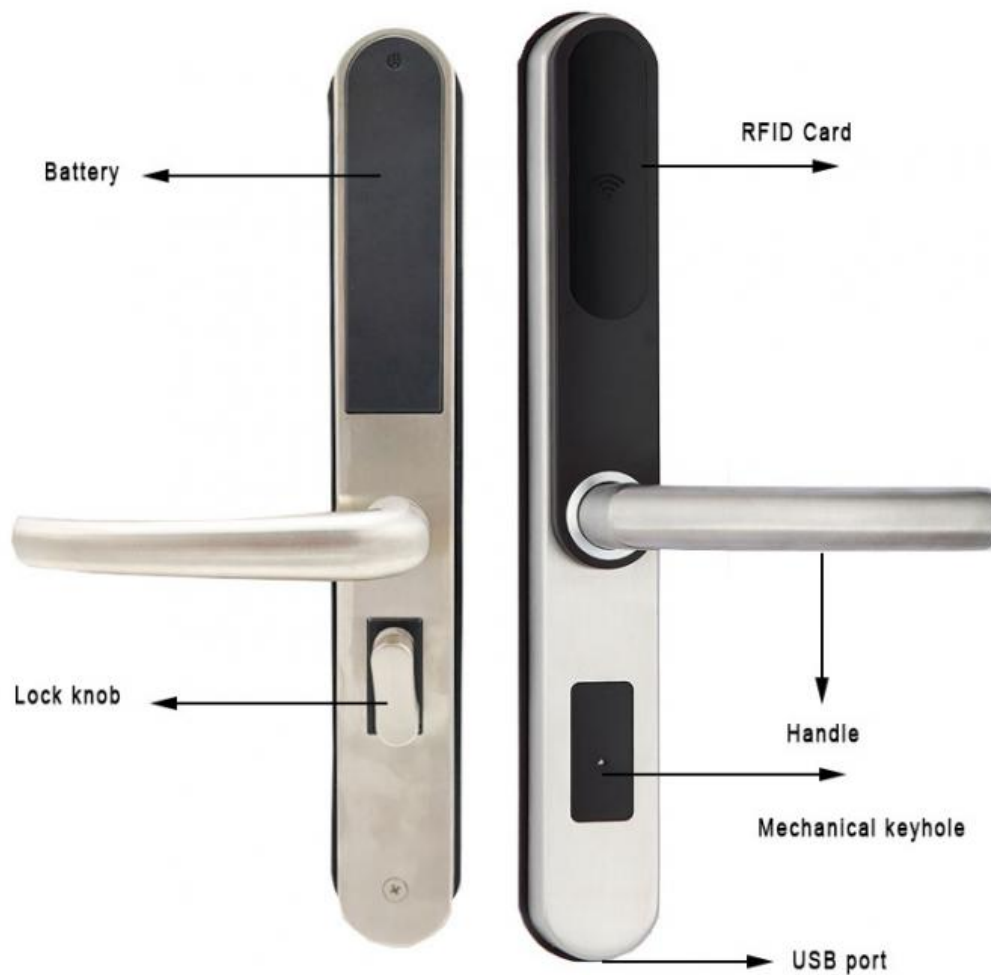

20,000 Circle Test

Passed America military ANSI/BHMA A156 Test
last more than 20,000 circles





Electronic Hotel Lock

1. Standalone electronic door lock with RFID technology.
2. Compatible with Ela ENergy Saver

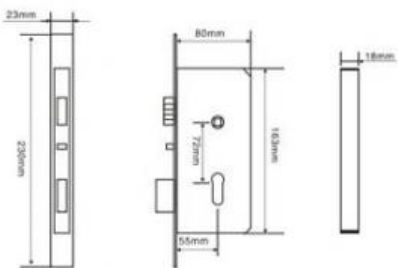
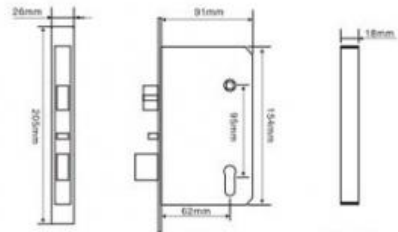
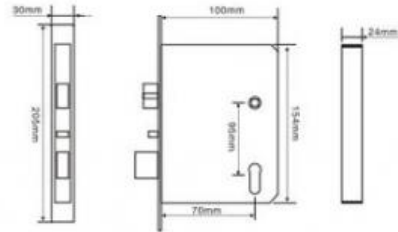

Product packaging

Security Bluetooth Electronic Hotel Keyless High Quality Combination Silm Smart Door Lock

1.Packing Size(W*D*H):490*360*450mm

2.Package sort:PP bag+foam

3.Net/Gross Weight(KGS):17.5/17.8

4.Qty/Carton:6 pieces in one carton

DELIVERY TIME of ela HOTEL LOCK:

ELA hotel lock will be delivered within 7-15 workdays according to your quantity. And we have very good cooperation relation ship with shipping cost, it can help to save cost for you. No matter you choose DHL, FEDEX, UPS, EMS or other transportation way, we will find the best solution for you.



reception



Product parts



working



working
environment



work shop



staff member

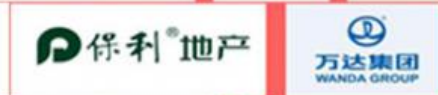

Certifications

Our services

ELA HOTEL LOCK SERVICE:

1. 2% of contract spare parts, which includes motor, battery case and PCB.
2. Hole Opening Diagram., Installation Manual Book , Installation Video &Software CD.
3. Door Strike Plate, Metal Strike plate box.
4. Sales after service: 2 years warranty and life time free service. During this period any spare parts damaged by lock itself, we will change for free.



OEM services

1. logo on Devncc
2. Welcome Screen
3. Pre-installed APP
4. Android Settings
5. Packing Box

ODM services

1. PCAB Design & Developmet
2. Tooling Design & Development
3. Software Customization.

FAQ

1. Are you a factory or a trading company?

A: we are a factory, is a professional manufacturer of smart locks and smart home system products we have our own R & D and design team, have their own smart lock core technology and product patents, all our products are 100% of the original factory. We do not sell non-original products at a low price, we can provide you with quality original products and good service and competitive prices, 25-5% lower than the market price.

2. Do you accept the OEM project? Can you produce our design products?

A: yes, we welcome ODM and OEM projects. All our products and packages accept ODM and OEM,. We have strong R & D capabilities. We have a professional and efficient R & D design team, as long as you have good ideas and projects. We can help you do it. We can design new smart locks and also can design your own APP software according to your requirements, including customizing your satisfactory software and firmware.

3. Can I print my logo on the product? How much do I have to pay?

A: yes. First of all, please formally inform us before production and confirm the design effect of the logo according to our

samples. Only need to pay some logo service cost, the cost is based on your order quantity, when your order quantity reaches our minimum order quantity, there is no additional charge for us.

4. What is your quality?

A: we control the whole production process in accordance with iso international quality standards. We always attach importance to quality control from the beginning to the end of production. We already got ISO9001, EN148456, CE, OPERA certifications. Each product will be fully assembled and carefully tested before packaging and transportation, and each product will be checked one by one before leaving the factory to ensure that the product quality is 100% qualified, passed quality control, and improved customer satisfaction. Establish long-term strategic partners with customers.

5. May I order for some samples?

A: yes, we welcome the order of samples for testing and quality inspection, mixed samples are also acceptable, but you need to pay, you can order directly from Alibaba, when you confirm that



