

Security Electronic Hotel Keyless Entry Locks / RFID Door Lock For Hotels

Our Product Introduction

for more products please visit us on smartdoor-lock.com

Basic Information

- Place of Origin: Guangdong, China
- Brand Name: ELA
- Certification: ROHS/CE/EN14846/ISO9001
- Model Number: H01
- Minimum Order Quantity: 100 sets
- Price: Negotiable
- Packaging Details: Security Bluetooth Electronic Hotel Keyless High Quality Combination Silm Smart Door Lock
Inner Paper Packing: 180mm*325mm*135mm
One piece per box
Outside Paper Carton: 680mm*380mm*385mm 8 pieces per carton. G.W: 23.5KG



Product Specification

- Network: SDK
- Product Name: Hotel Keyless Entry Locks
- Application: Apartments/Hotel
- Color: Silver, black
- Door Type: Glass Door, Wood Door, Steel Door, Stainless Steel Door, Aluminum Door
- Door Thickness: 35-90mm
- PMS: Fidelio/Opera/Others
- Unlock Way: Card+Mechanical Key
- Warranty: 2 Years
- Material: 304 Stainless Steel
- Port: Shenzhen/goangzhou
- Highlight: Security Hotel Keyless Entry Locks, Electronic Hotel Keyless Entry Locks, RFID Door Lock For Hotels



More Images

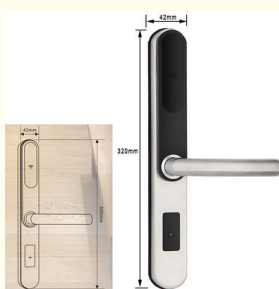

Product Description

Security Electronic Hotel Keyless High Quality Combination Silm RFID Hotel Lock

parts	Material	Technology surface treatment
lock tongue	Zinc Alloy	Light branding
side tongue	Zinc Alloy	Light branding
panel	304 stainless steel	Anodizing
handle	304 stainless steel	Anodizing
for lock core	HD#(62*95mm)	HK#(70*95mm)

Product Description

In today's fast-paced world, technology has transformed the way we live and work. The hospitality industry is no exception, adopting innovative solutions to enhance the guest experience and ensure security. One such solution is the Security Electronic Hotel Keyless High Quality Combination Silm RFID Hotel Lock - a smart and secure door lock that utilizes RFID technology to provide guests with a seamless and convenient entry and exit experience.



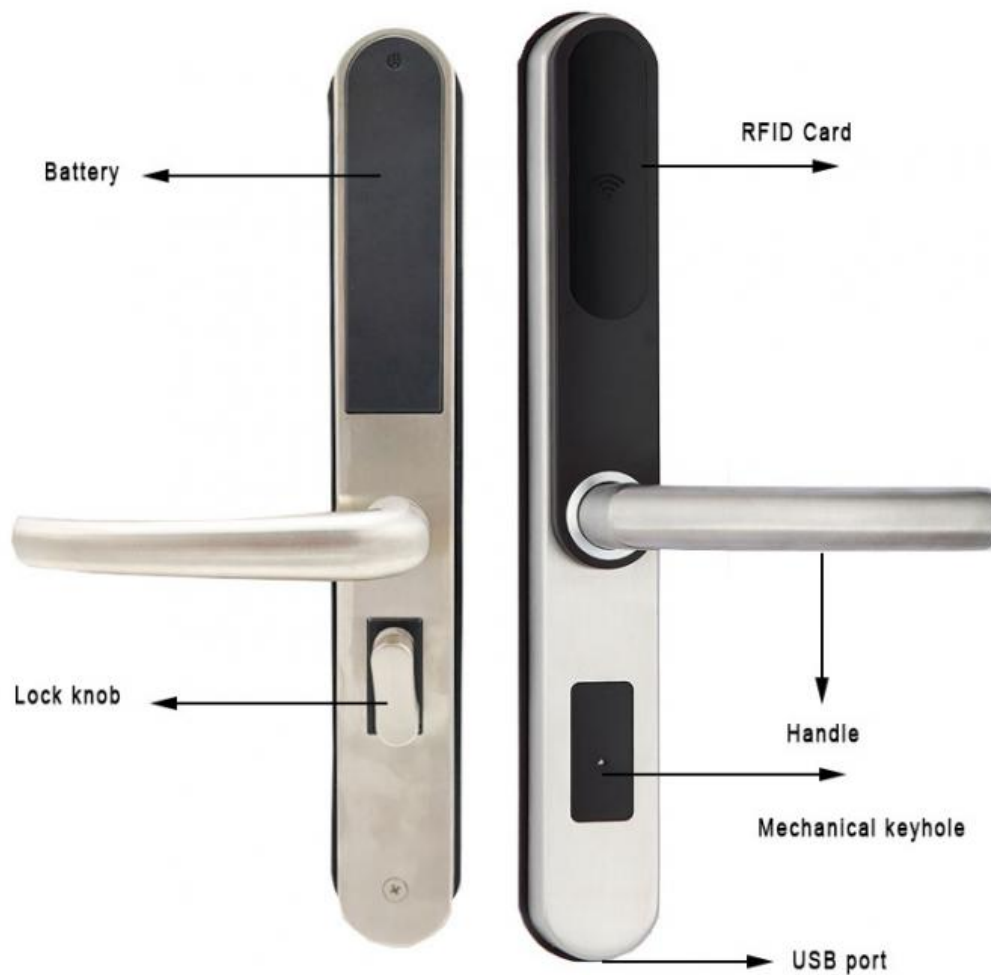

20,000 Circle Test

Passed America military ANSI/BHMA A156 Test
last more than 20,000 circles





Electronic Hotel Lock

1. Standalone electronic door lock with RFID technology.
2. Compatible with Ela ENergy Saver

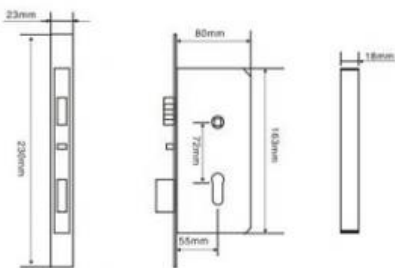
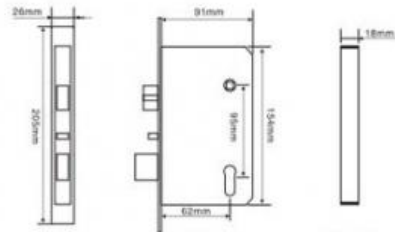
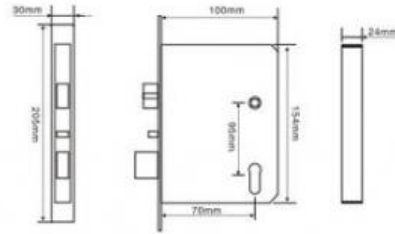

Functional Characteristics:

Interface with most of the PMS system,Fidelio/ELA registered!

Made of 304 stainless steel, with a service life of up to ten years

After unlocking with a card, the sensor area will light up a blue light to indicate that the door lock is open.

Power:4 PCS#5 AA Alkaline batteries:14 months' duration

Door lock can store 830 unlocking records

Low battery automatic reminder

Using international 5 tongue structure, more secure against theft

Product packaging

Security Electronic Hotel Keyless High Quality Combination Silm RFID Hotel Lock

1. Packing Size(W*D*H):490*360*450mm

2. Package sort:PP bag+foam

3. Net/Gross Weight(KGS):17.5/17.8

4. Qty/Carton:6 pieces in one carton

DELIVERY TIME of ela HOTEL LOCK:

ELA hotel lock will be delivered within 7-15 workdays according to your quantity. And we have very good cooperation relationship with shipping cost, it can help to save cost for you. No matter you choose DHL, FEDEX, UPS, EMS or other transportation way, we will find the best solution for you.



Company Profile

CULTURE

March 2016 Honglg Electronic Factory is updated to Dongguan Yinlang Electronic Technology Col,Ltd. Welcome new and old customersto visit our company.

About ELA:

Established in 2002 initially name was Dongguan Shijie HongLG Electronic Factory;

In 2004 manufactured the first aluminum alloy material electronic hotel lock in China;

In 2005 manufactured the first split model electronic hotel lock HD8018, HD8019 in China;

In 2006 supplied over 2000 locks for Doha Asia Games Athlete apartment.;

In 2007 developed the first biometric fingerprint lock;

In2009 supplied for 2nd Summer Youth Olympic Games Athlete apartment;

In 2011 supplied for 10th national games Athlete apartment;

In 2012 the first face recognition lock in China;

In 2013 supplied for 12th National Games Athlete apartment;

In 2016 updated to Dongguan Yinlang Electronic Technology Co. Ltd

We keep moving....



reception



Product parts



working



working
environment



work shop



staff member



Certifications

Our services

ELA HOTEL LOCK SERVICE:

1. 2% of contract spare parts, which includes motor, battery case and PCB.
2. Hole Opening Diagram., Installation Manual Book , Installation Video &Software CD.
3. Door Strike Plate, Metal Strike plate box.
4. Sales after service: 2 years warranty and life time free service. During this period any spare parts damaged by lock itself, we will change for free.



OEM services

1. logo on Devnce
2. Welcome Screen
3. Pre-installed APP
4. Android Settings
5. Packing Box

ODM services

1. PCAB Design & Developmet
2. Tooling Design & Development
3. Software Customization.

 **Yinlang** Dongguan Yinlang Electronic Technolog Co.,Ltd



13926821097



Linda@honglg.com



smartdoor-lock.com

10-3 The First Industrial Park, Chong Huan West Road, Shijie town, Dongguan City, Guangdong, China